

AIRWOOD
VISUAL POSITIONING MODULE

MODULE INSTRUCTIONS

The visual positioning module uses the lens of the visual sensor to continuously capture and analyze the ground pattern to calculate the displacement of the module in the horizontal direction, and sends the relevant data to the flight control, thereby enabling the aircraft to achieve the horizontal positioning function.

MODULE COMPONENTS

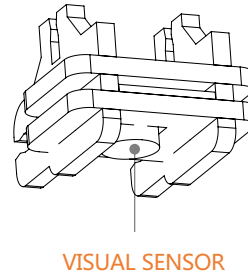
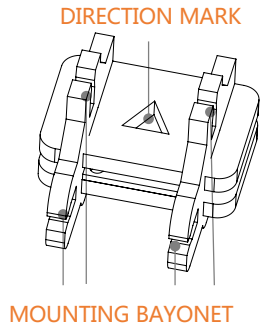

INSTRUCTIONS

Install to drone frame by
mounting bayonet

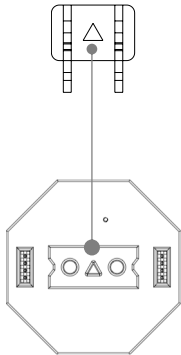

Make sure the Visual Module is
IN THE SAME DIRECTION
with Flight Controller Module

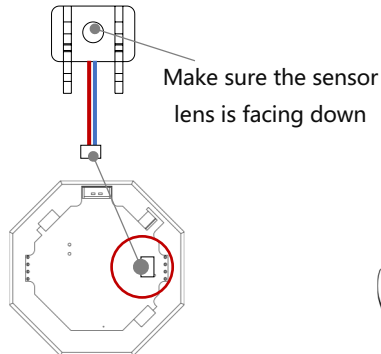

Insert the plug of the
module into the connector
on the back of the flight
control.

INSTALLATION EXAMPLE

